

YLANG YLANG

Falcon



YLANG YLANG

Cruising



SPECIFICATIONS

Length	31.50m (103' 4»)
Beam	6.50m (21' 4»)
Draft	3.10m (10' 2»)
Year built	2007
Year refit	2011
Builder / Interior Designer	Falcon
Number of Cabins	5
Total Guests (Sleeping)	12
Total Guests (Cruising)	12
Max Guests for Events	50
Cabin Configuration	3 Double, 2 Twin
Total Crew	5
Number of Beds	7
Bed Configuration	2 Pullman, 3 Queen, 4 Single
WiFi	Yes
Hight Rate	50,000€/week (Terms: + ALL)
Low Rate	48,000€/week (Terms: + ALL)
Current Winter Base Port	SOF
Current Summer Base Port	Cannes

EQUIPEMENT

Engines	2 x 2000 CV MTU 16V 2000 M91 2 X 27 KW KOHLER
Cruising speed	20 knots
Max speed	24 knots
Fuel consumption	500 Litres/Hr

WATER SPORTS

- Tenders + toys: 4,20m Novurania 60hp Yamaha
- Jet ski Yamaha GP 800R
- Seabob Jet 4.12
- Donuts
- Water skis for both adults & children
- Wakeboards for both adults & children
- Snorkeling equipment
- Stand Up Paddles

















YLANG YLANG

Bathroom



YLANG YLANG

Twin Cabin with Pullman







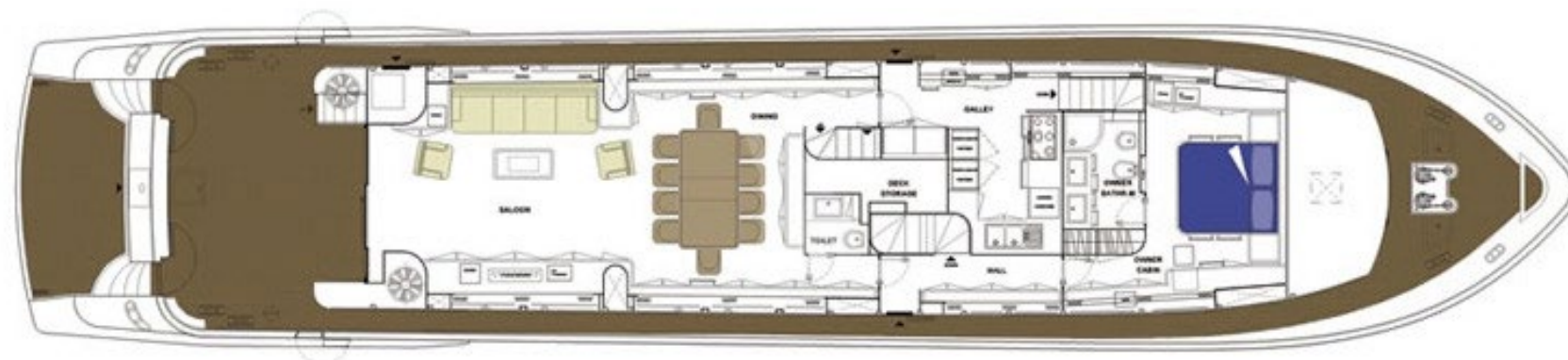
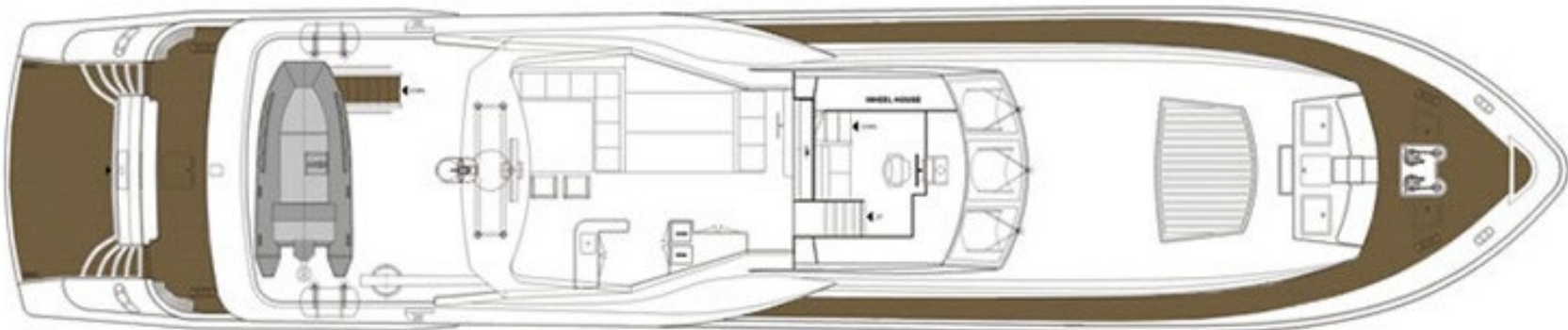

YLANG YLANG