

YACHT
NEXT AVAILABLE DELIVERY

SANLORENZO

SX
88/











05. Dining area











10. Owner's bathroom

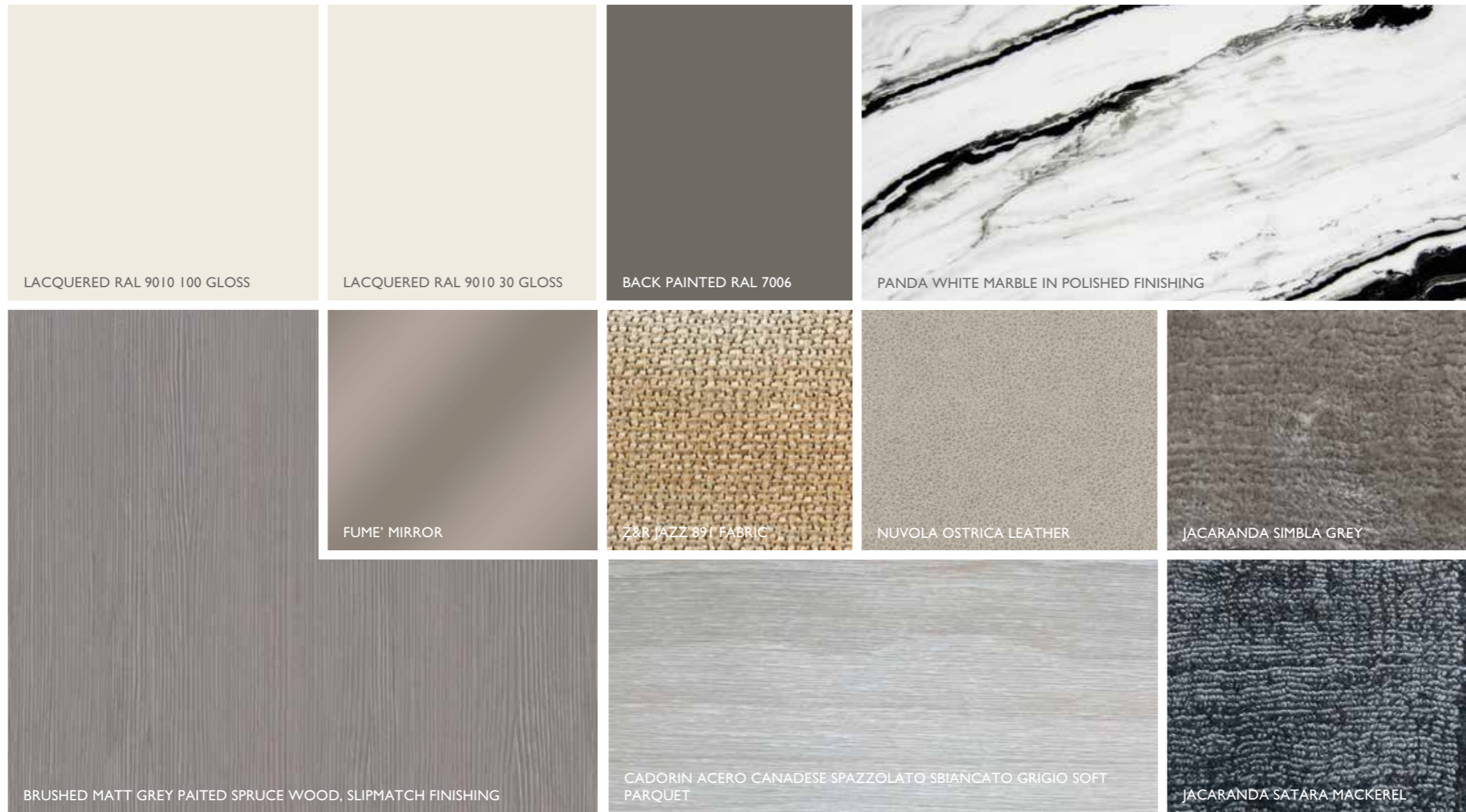



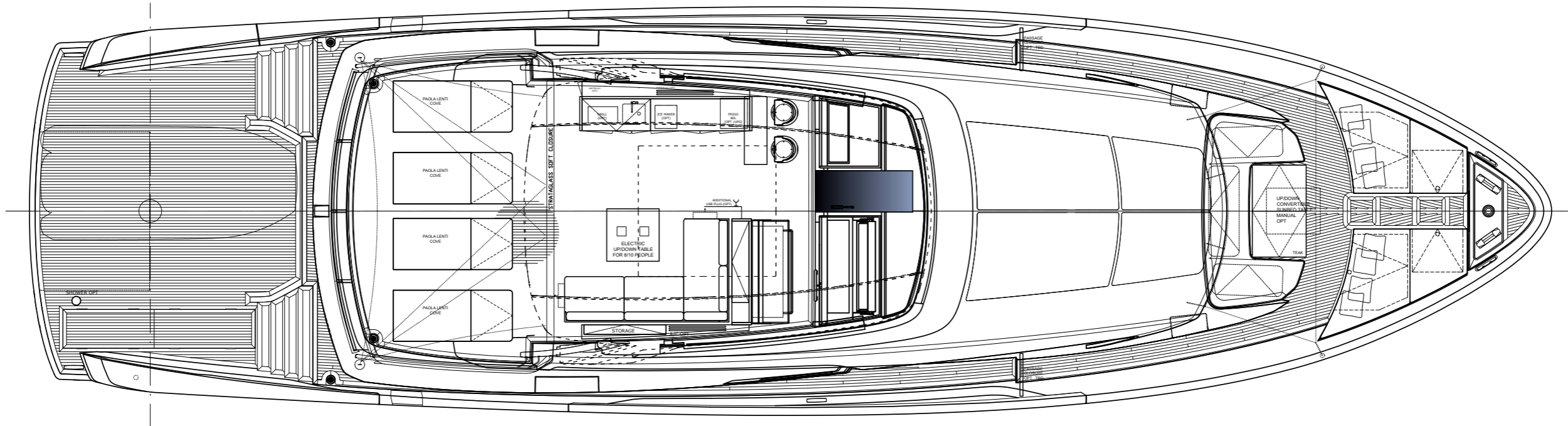

Fly bridge open table

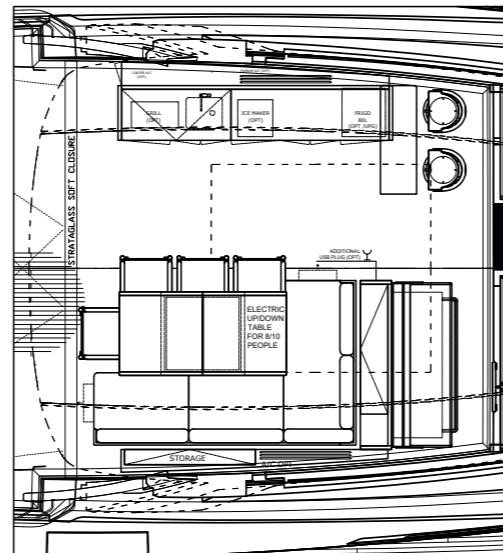

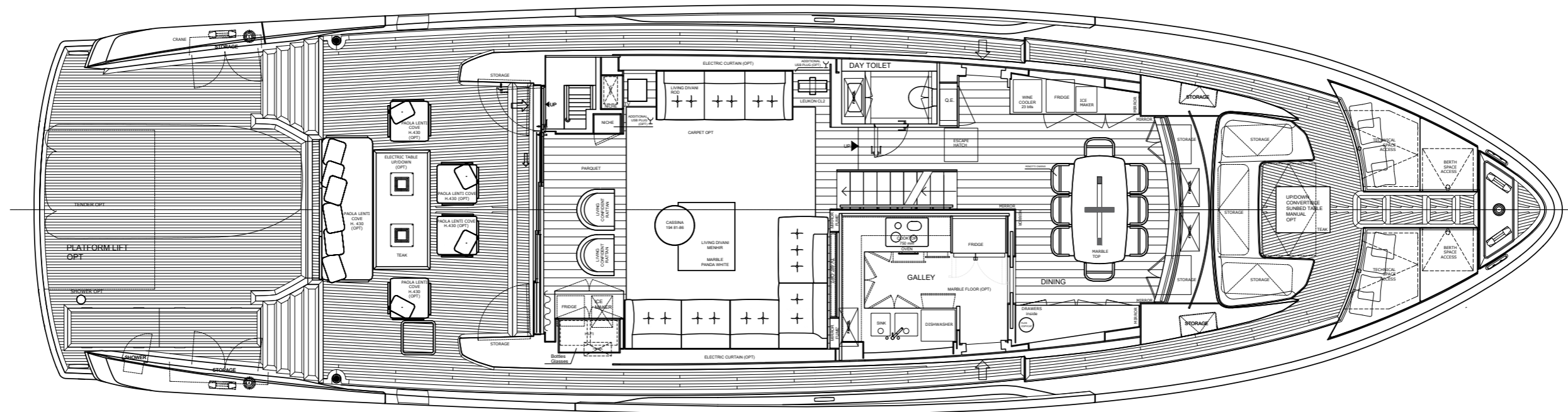

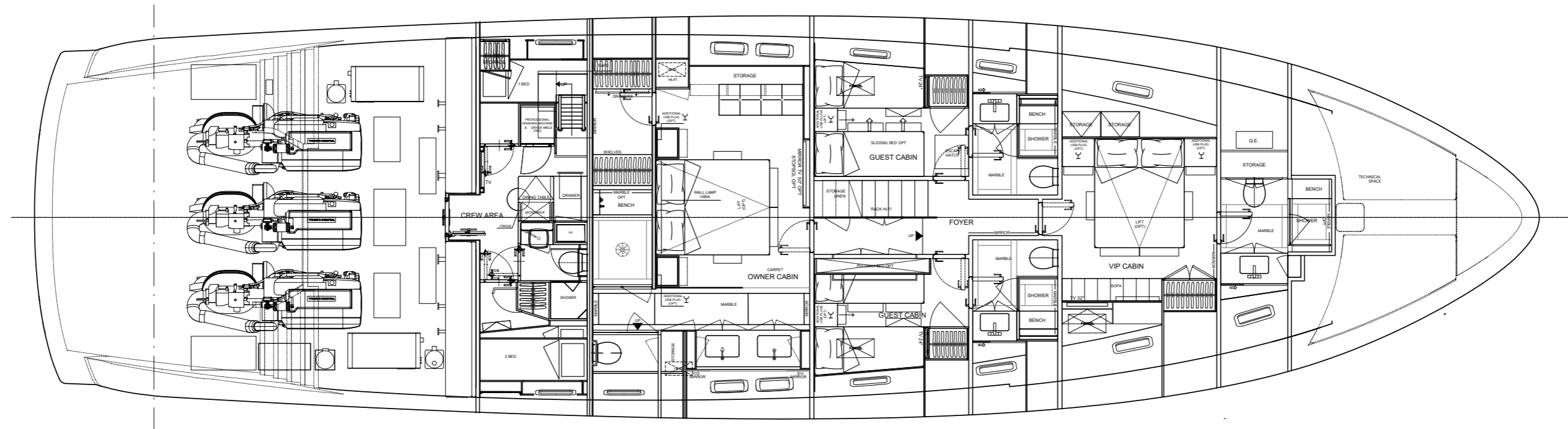

OPTIONS LIST

PRICES (€)

ALARMS AND CONTROLS

Battery charger for generators	2.500
No. 1 additional waterproof 220V socket in flybridge bar cabinet	500
No. 1 additional waterproof 220V socket in beach area front storage	500
No. 1 additional USB socket on helm station	500
No. 2 additional USB sockets in salon	600
Dimmer package for exteriors	7.500
Dimmer package for interiors	7.000

ALARMS AND CONTROLS

CCTV IP: 2 fixed in cockpit, 2 fixed in engine room	10.000
Additional touch screen monitor for ship monitoring in crew mess	7.000
1 Raymarine diamond navigation package (diff. from standard)	20.000
Raymarine integrated dashboard system	27.500

SATELLITE AND COMMUNICATION SYSTEMS (TV SAT)

Seatel ST24E TV-Sat antenna	18.500
Seatel ST24E empty radome	1.500

AUDIO AND VIDEO APPLIANCES*

4G Wi-Fi system with harbour hot spot antenna	14.000
Audio-video diamond package (diff. from standard)*	32.500
TV 65" in salon (diff. from standard)*	2.600
No. 6 Apple TVs: no. 1 in salon + no. 4 in cabins + no. 1 in crew area	12.000

OPTIONS LIST

PRICES (€)

HOUSEHOLD APPLIANCES

Icemaker in flybridge bar	2.500
Grill in flybride bar cabinet	2.500
Miele cooking top 75cm (diff. from standard)	1.100
Wine cooler for 23 bottles in dining area	2.500
Additional icemaker in dining area	2.800
Additional fridge in dining area	2.800

INTERIOR ACCESSORIES

Brushed matt gray painted spruce wood, slipmach finishing, throughout the boat (diff. from standard). N.B.: this wood is subject to color change in time based on the the exposure to the sunlight (UV rays), and it's not uniform in terms of color and veneers.	16.500
Bow wall in salon with "Mondrian design" in mirror and metal frame (diff. from standard)	4.750
Bar cabinet in wood in aft salon, wood and glass storage cabinet	5.200
Super Tuft Simla grey moquette (diff. from standard)	7.200
Brushed metal throughout the boat (diff. From standard)	6.100
Parquet floor in salon (diff. from standard)	12.000
Lift system for vip and owner's beds	2.000
No. 4 electric decorative curtains in owner's cabin, standard fabric (diff. from standard). Push-button control	7.200
No. 2 electric decorative curtains in salon, standard fabric (diff. from standard). Push-button control	3.600
No. 2 electric blackouts in owner's cabin. Push-button control	5.000
Olivari Link superinox sat. finishing handles	1.100
Zucchetti Jingle polished chrome finishing faucets and Zucchetti Soft polished chrome finishing bathroom's accessories in every bathrooms	Standard
Headshowers in vip and both guest cabins (standard in owner's)	3.300

OPTIONS LIST

PRICES (€)

Wc with integrated bidet shower - do not install bidets	Free of charge
Pullman bed in starboard guest cabin	8.500
Sliding bed in portside guest cabin	8.500
Additional insulation for fin boxes	1.800
Wall above the bed in vip cabin in Z&R Marco Polo 10745684 fabric (diff. from standard)	1.250
Led strip under beds in owner's and vip cabins	4.000
Led strip behind curtains in salon	4.000
Palagi art. 7000 matt finishing for switches and sockets throughout the boat (diff. from standard)	8.000
Zucchetti Aguablu polished finishing faucets and Zucchetti Aguablu polished finishing bathroom's accessories (diff. From standard)	3.700
Stopsol mirror for TV in owner's cabin	1.800
Foresti & Suardi round, lacquered ral 9010 100 gloss spotlights throughout the boat (diff. from standard)	3.300
Panda White marble for no. 1 marble wall in owner's bathroom, no. 1 marble wall in vip bathroom in polished finishing (diff. from standard)	15.000
Panda White marble floor in polished finishing in every bathroom (diff. from standard)	6.000
Panda White marble top in polished finishing in every bathroom (diff. from standard)	2.000
No. 6 Panda White marble integrated sink in polished finishing in every bathroom (diff. from standard)	11.500
Panda White marble top for dining table	3.200
Galley floor in Nero Zimbabwe granite (diff. from standard)	4.300
Marset led tube wall reading lamps in aluminium in every cabin (diff. from standard)	1.500
Decorative lamp on wall over the bed in owner's cabin: Vibia Puck Wall Art (art. 5486 + art. 5474 + art. 5470 + art. 5471)	3.300
Aft wall in owner's bathroom in Panda White marble in polished finishing (diff. from standard)	2.700
No. 1 wall inside shower in starboard guest cabin in Panda White marble in polished finishing (diff. from standard)	5.000
No. 1 wall inside shower in portside guest cabin in Panda White marble in polished finishing (diff. from standard)	

OPTIONS LIST

PRICES (€)

No. 1 SuperTuft Satara Mackarel carpet in salon	3.400
No. 2 aft armchairs in salon: Living Divani Confident "Rattan" with anthracite grey rattan and Mikado I6 grigio fabric for seat pillows	2.600
No. 1 coffee table like Living Divani Menhir in Panda White marble in polished finishing (diff. from standard)	4.600
No. 1 Cassina I94 81-83 coffee table with backpainted red glass and Bback Maequina base	
No. 1 Cassina Cicognino 834 small table in black stained ash	1.000
No. 1 Maxalto CL2 decorative floor lamp with bronze structure and beige lampshade	1.700
Medicine cabinet above wc in ral 9010 30 gloss lacqued in daily toilet	1.600
No. 8 Minotti Owens chairs without armrests in Minotti Adachi 04 bianco fabric (art. 29) and Moka structure (diff. from standard)	3.500
No. 1 Living Divani Rod L-shaped sofa and no. 1 Living Divani Rod sofa in Mikado I6 avorio fabric and New Scotland col. 302 leather structure (diff. from standard)	1.000
Credit for missing supply of standard bedspreads for every cabin	-3.940,00
Lineta Mare bed linen and towel	5.500
Alessi furniture	3.000
EXTERIORS ACCESSORIES	
Hardtop with electric opening roof system with blades	35.000
Air conditioning on fly bridge (including modification of cabinet)	14.000
No. 6 underwater lights: no. 4 on transom + no. 2 on sides aft	18.000
Swimming platform lifting system	40.000
Table with hi-lo manual system at bow, transformable into sunbed with additional cushion	8.500
Electric hi-lo table on flybridge (diff. from standard)	3.500
Removable stainless steel column shower on beach area aft	7.000
Table with electric hi-lo system in cockpit	12.000
Sun awning for the stern area of the flybridge behind the hardtop	5.000

OPTIONS LIST

PRICES (€)

Grey teak floor on flybridge (no warrenty for color)	43.000
Bow area bimini top	7.500
No. 1 Paola Lenti Cove sofa with removable armrests and seating height h430 mm in cockpit in Paola Lenti Rope T29 silver fabric and Rope M29 silver fabric structure (diff. from standard)	1.200
No. 4 Paola Lenti Cove armchairs with seating height h430 mm in cockpit in Paola Lenti Rope T29 silver fabric and Rope M29 silver fabric structure	18.300
Portside bar cabinet with glacier white corian top and sides and natural teak doors on flybridge (diff. from standard)	10.000
U-shaped bow bar cabinet in brushed steel on flybridge	4.200
No. 2 stools for Atep bar cabinet, revolving model, in Aisi 316L cod. 20 BSI04 stainless steel and Maria Flora Insieme acero 60002 col. 929307 fabric on flybridge	3.200
Starboard side air conditioning cabinet with storage in natural teak on flybridge	4.400
Portside air conditioning cabinet with storage in natural teak on flybridge	5.700
Custom sofa on flybridge with drawers, natural teak structure and seat and backrest pillows in Maria Flora Insieme Acero 60002 col. 929307 fabric (diff. from standard)	11.500
Electric hi-low table with folding top for 8/10 people in natural teak and stainless steel base (diff. from standard)	1.300
No. 5 Roda Orson folding chairs with teak structure and canatex sand fabric (diff. from standard)	900
No. 2 Paola Lenti Rams double sunbeds with white structure and Paola Lenti Rope T29 silver fabric (diff. from standard)	500
THRUSTERS AND STABILIZERS	
Zero Speed electric stabilizers (at anchor and under navigation)	150.000
Second control station with only Volvo IPS joystick in aft cockpit (no engines levers)	10.000

OPTIONS LIST

PRICES (€)

ENGINE ROOM EQUIPMENT

No. 1 Idromar 180 lt/h watermaker	15.000
Electric pump for oil change for engines and generators	3.000
Upgrade to 150 lt boiler (diff. from standard)	850
Foot switch for stern warping with reverse option (double switch)	2.000
Upgrade to second 28kW generator (diff. from standard)	10.000
Backlit boat name predisposition	800

TOTAL (VAT Excluded)

822.510

***these options are not subject to any discount**

Length overall	26,70 m
Maximum beam	7,20 m
Construction height	3,25 m
Displacement @ half load (*)	82 t
Displacement @ full load (*)	88 t
Waterline length @ half load	23,45 m
Waterline length @ full load	23,51 m
Draught @ half load	1,68 m
Draught @ full load	1,70 m
Guest accommodation	8 people
Crew accommodation	3 people
Engine	3 X IPS3 I050 VOLVO D13B - 800 HP
Consumption (approx) (**)	3 x 125 l/h @ 2200 rpm
Power output @ 100% MCR (**)	3 x 588 kW @ 2300 rpm
Gearbox	3 x IPS3
Transmission	3 x IPS3
Propeller	Volvo IPS propellers
Shafts	N/A
Gensets	1 x 25 kW + 1 x 20 kW
Rudders	N/A
Maximum speed (approx) (***)	23 kn
Cruising speed (approx) (***)	20 kn
Economical speed (approx) (***)	10 kn
Max range @ economical speed (approx.)	1210 nm
Deadrise	15°
A/C power	104000 btu/h
Fuel capacity	9300 l
Fresh water capacity	2000 l
Black water capacity	550 l
Grey water capacity	550 l
Tender length	max 4,50 m
Tender weight	max 1000 kg

* Displacement data refers to a yacht with standard layout as described in the sales specification
 ** Main engine performance data and characteristics are derived from the manufacturer's specification
 *** Speed data refer to a yacht with standard layout as described in the sales specification, considering a third of liquid weight, a third of luggage weight (25kg per bed) and 5 crew members (80kg each), and without stabilization system and hard-top.

It's not an investment if it's destroying the planet



INFUSION LAYUP SYSTEM

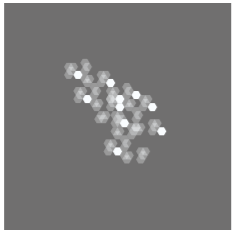

BIO RESIN & CORE



FSC CERTIFIED WOOD SUPPLY



FORMALDEHYDE FREE FURNITURE



LED LIGHTING



BIOCHROME®



SUSTAINABLE LEATHER



CLASS A++

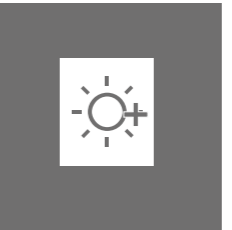

SOLAR PANELS



HULL EFFICIENCY



THERMAL INSULATION

This brochure shall not be regarded as a contractual offer regarding the sale of yachts from the shipyard to individuals or companies. All the information contained in this brochure, including without limitation any technical or performance data, pictures, and drawings, are mere indications with no contractual value and refer to standard motoryacht models from the shipyard on the date the brochure is issued.

This document is based on the information available at the time it is published. In spite of the commitment aimed at guaranteeing maximum possible accuracy, the information contained herein may not cover all the details and any technical-commercial modifications introduced after printing, or may describe features that are not present.