

YACHTS

SX
76/

SX
76/



SX76 PROJECT LEADING CHARACTERISTICS

CONCEPT

No helm station at main deck level
 Revolutionary “sea-friendly” stern design
 Direct connection between saloon to fore dinette area
 Multifunctional large Fly Bridge area (OPT)
 Lower deck/ Main deck modularity and customizability

TECHNOLOGY

Closable helm station and sun-deck area (OPT)
 Pod propulsion system
 Hull efficiency through tank testing sessions
 Modular assembling construction system

SUSTAINABILITY

Low impact construction materials and processes
 Low impact systems installation (Class A EU certified)
 Low consumption & emissions

The blueprint for all Sanlorenzo remains constant; characterful and exciting yachts built to the highest standards. SX76 is imbued with Power, Beauty and Soul, combining performance and sea keeping ability with passion, refinement, luxury and exceptional beauty.

SX
76/



SX
76/



SX
76/



Sophisticated and modern the new SX76 is a Sanlorenzo with peerless characteristics from a unique lineage.

PRELIMINARY

SX
76/



PRELIMINARY

SX
76/



PRELIMINARY

SX
76/



PRELIMINARY

SX
76/



PRELIMINARY

SX
76/

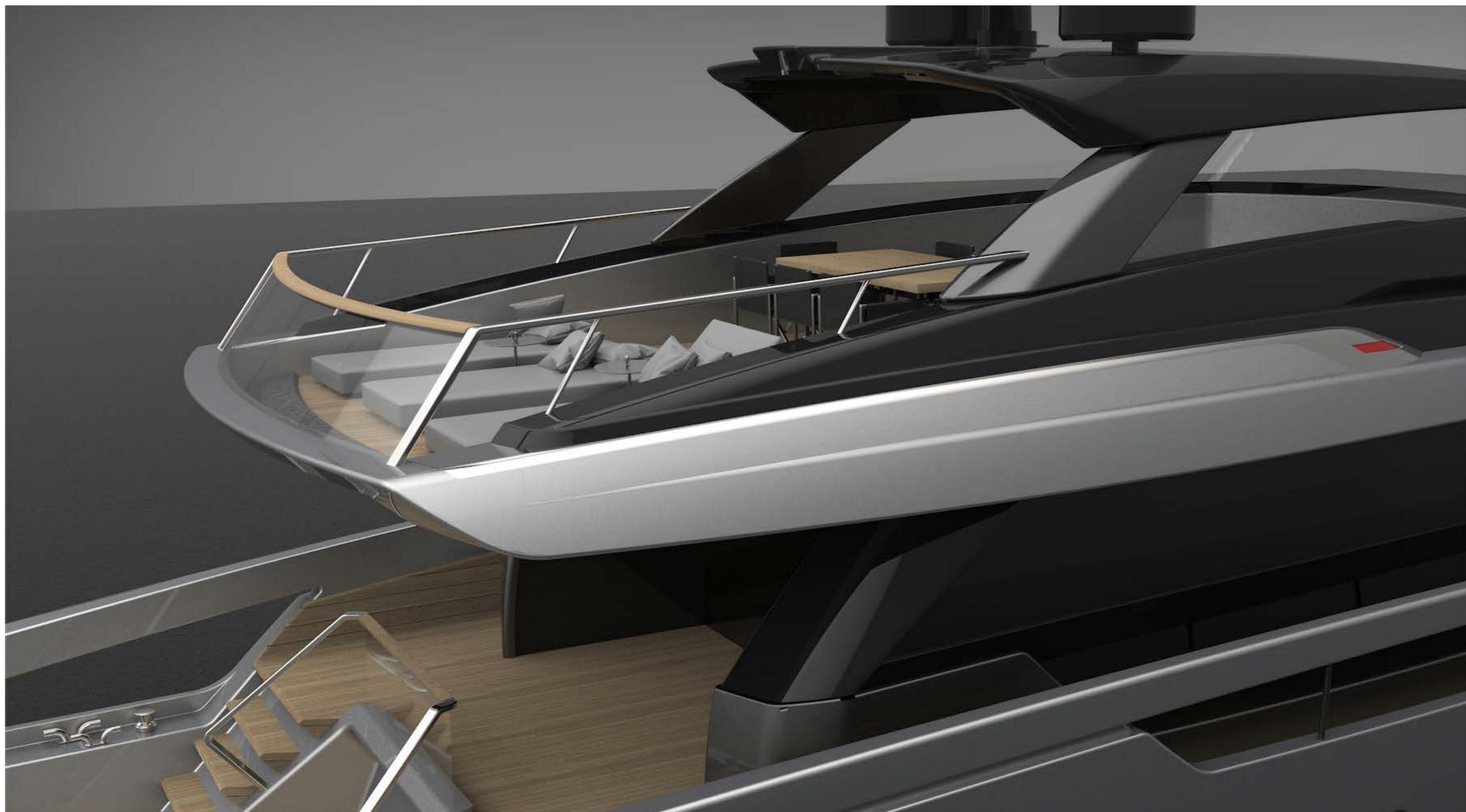

Fully enjoy the closable fly bridge with combined helm station

PRELIMINARY

SX
76/



PRELIMINARY



Fully enjoy the SX76 fore deck area connected to saloon and owner's stateroom

SX
76/

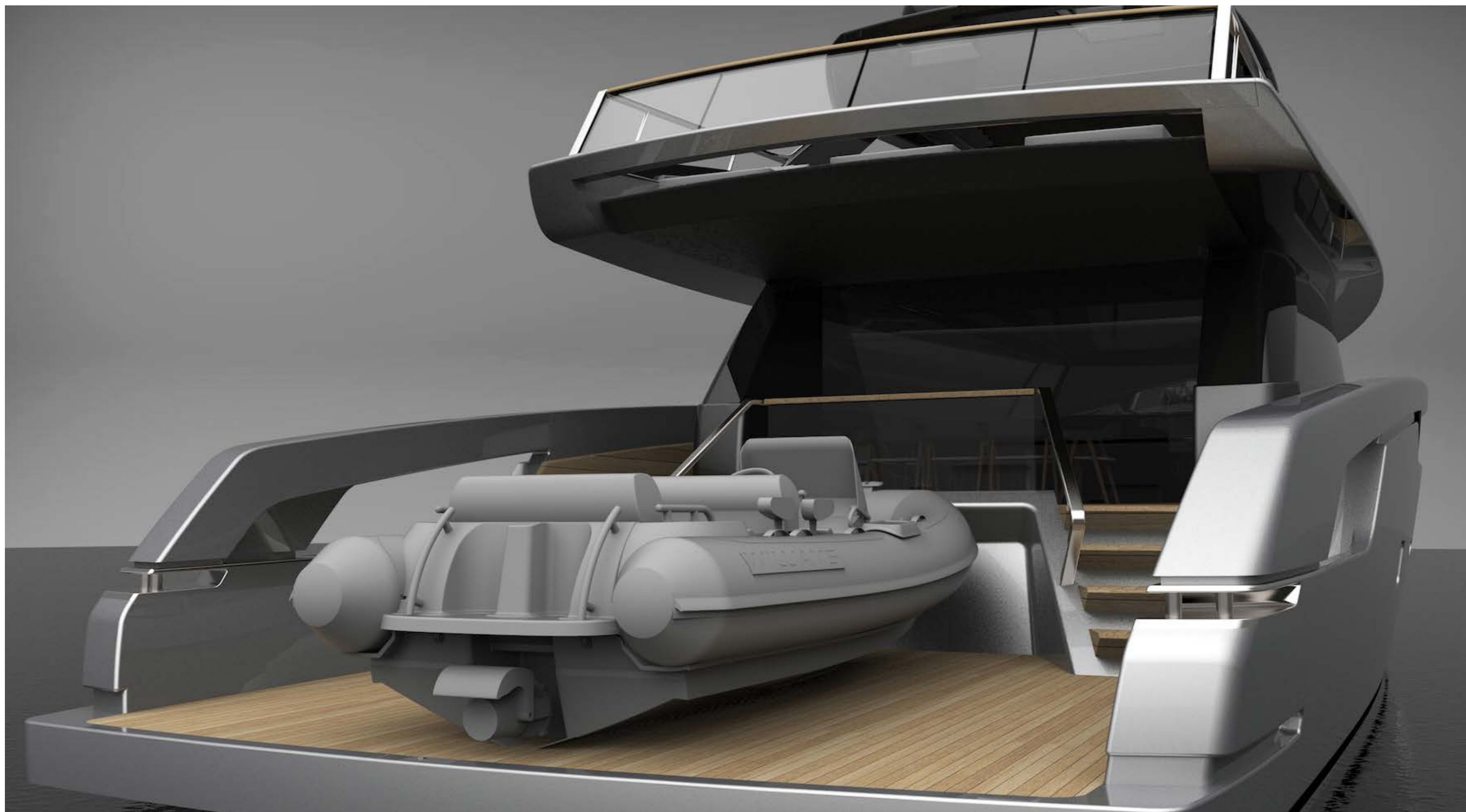

PRELIMINARY

SX
76/



Choose your own chromatic combinations to create your unique SX88

PRELIMINARY – FROM SX88

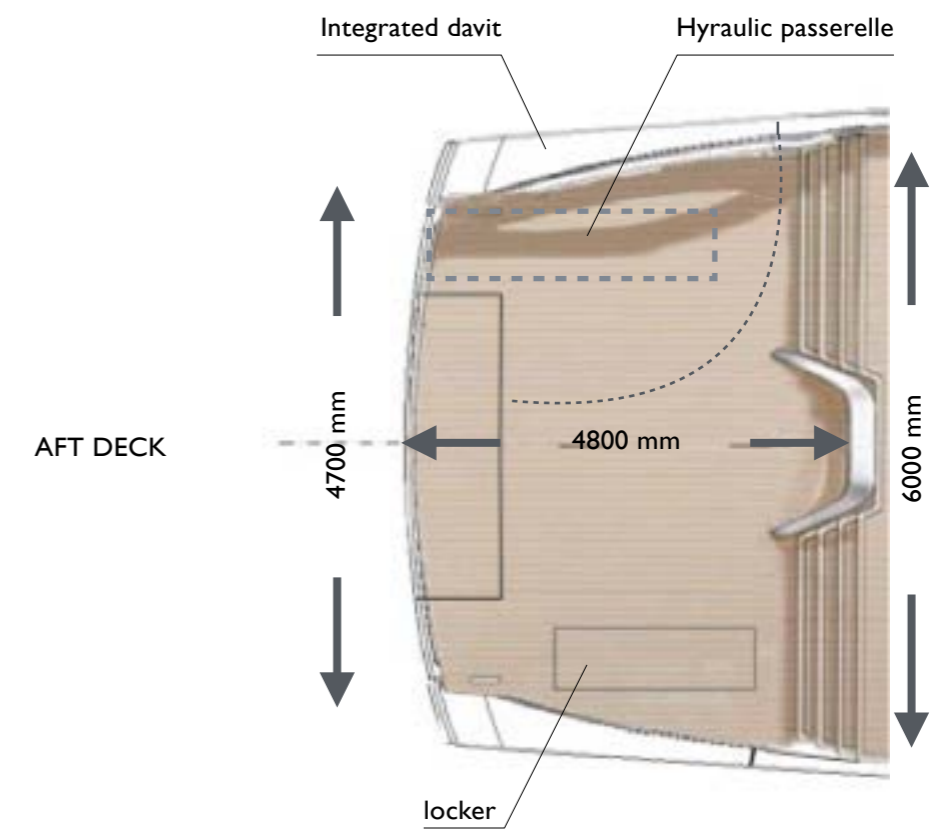

SX
76/





Salon - Decor option A



Salon - Decor option A



Salon - Decor option A



Salon - Decor option A



Owner's cabin - Decor option A



Owner's cabin - Decor option A



Owner's cabin - Decor option A



Owner's bathroom - Decor option A



Owner's bathroom - Decor option A



Salon - Decor option B



Salon - Decor option B



Owner's cabin - Decor option B



Owner's cabin - Decor option B



Owner's cabin - Decor option B



Owner's cabin - Decor option B



Salon - Decor option C



Salon - Decor option C



Salon - Decor option C



Owner's cabin - Decor option C



Owner's cabin - Decor option C



SX
76/



Profile

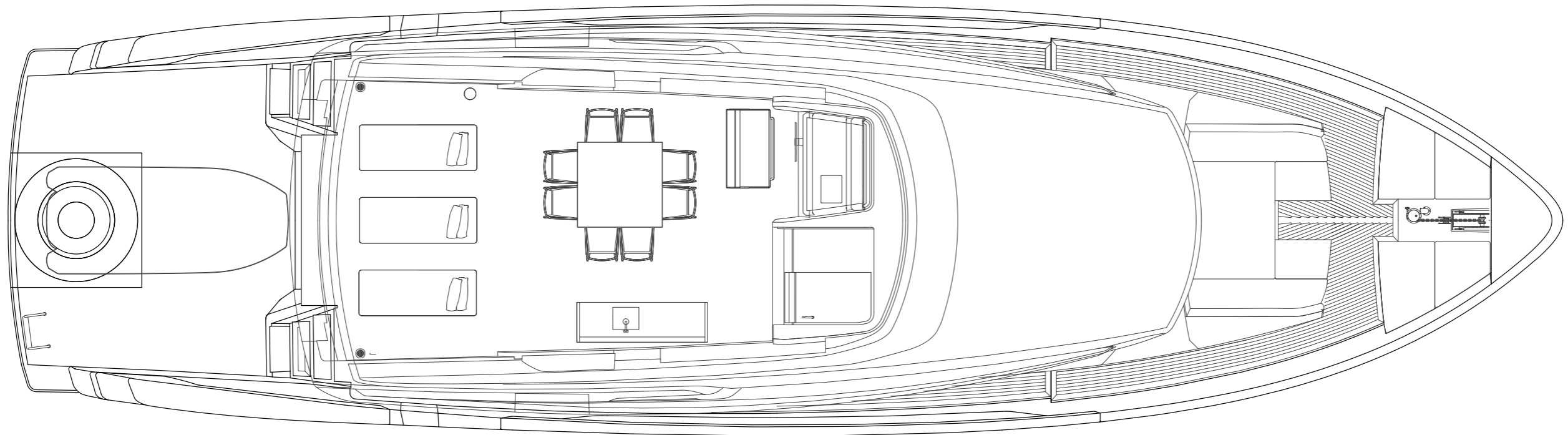

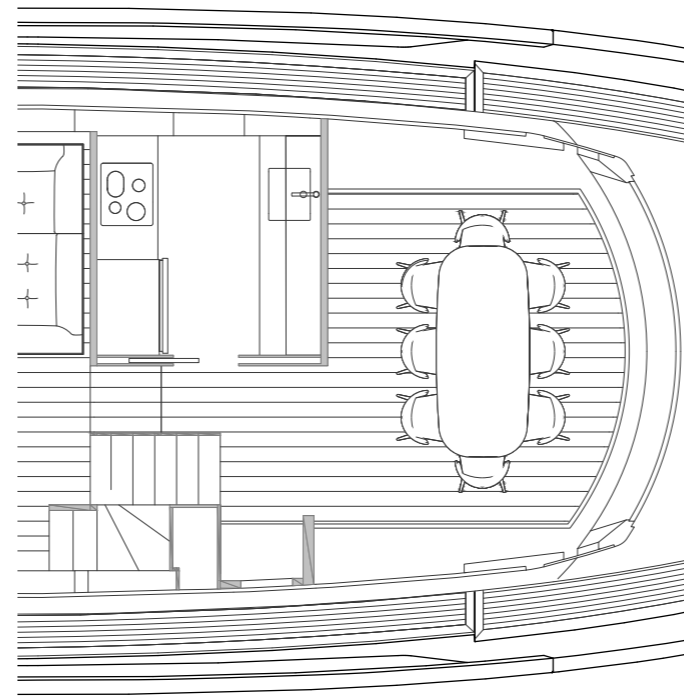
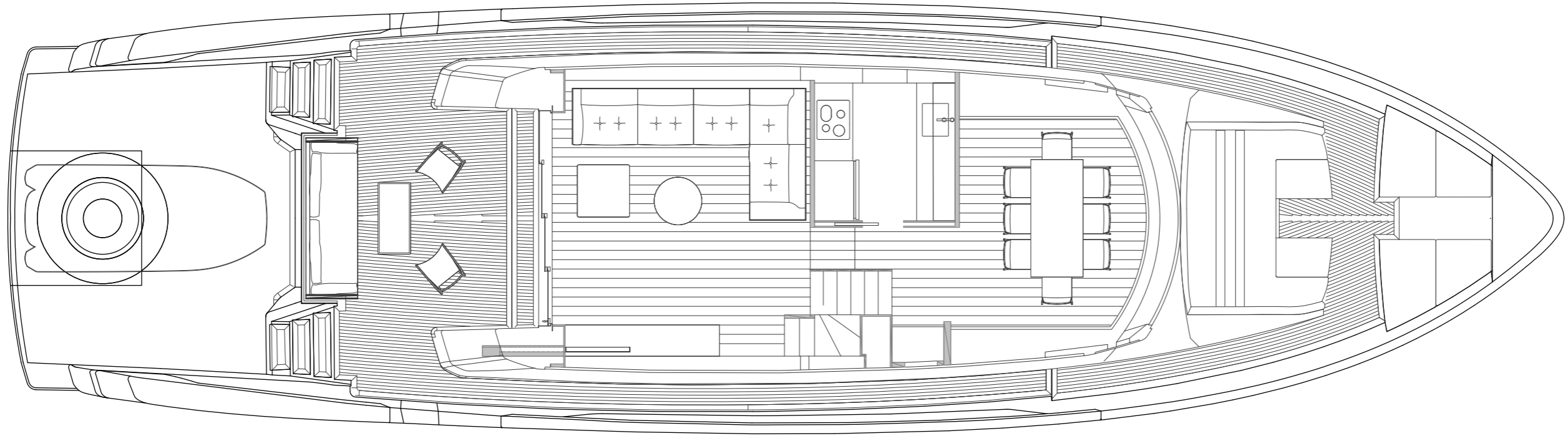

Alternative proposal
for dining area

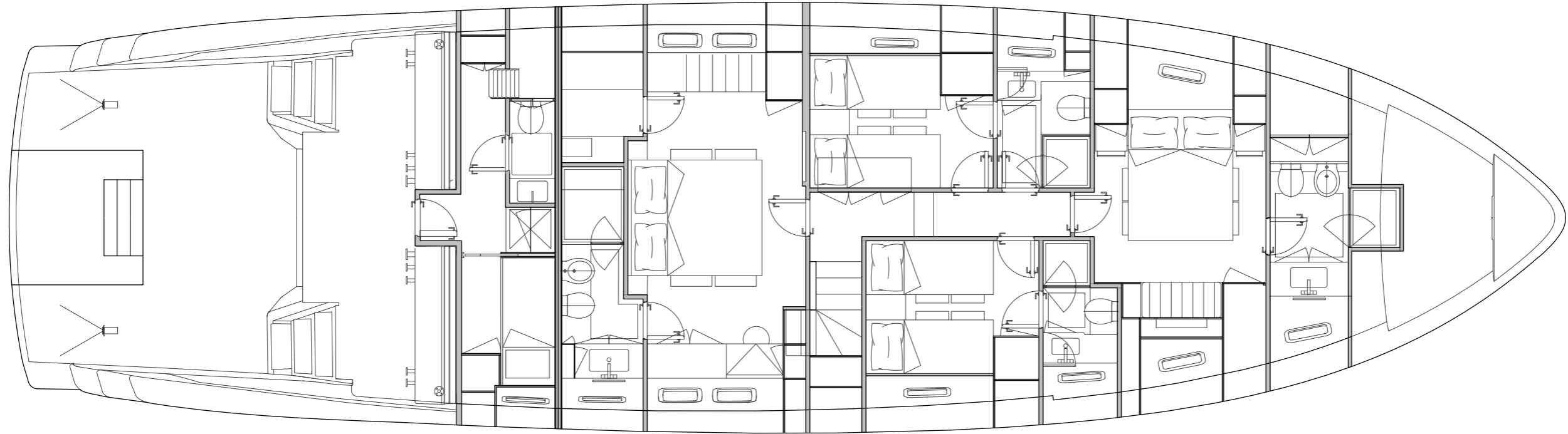

Alternative proposal
for owner cabin C

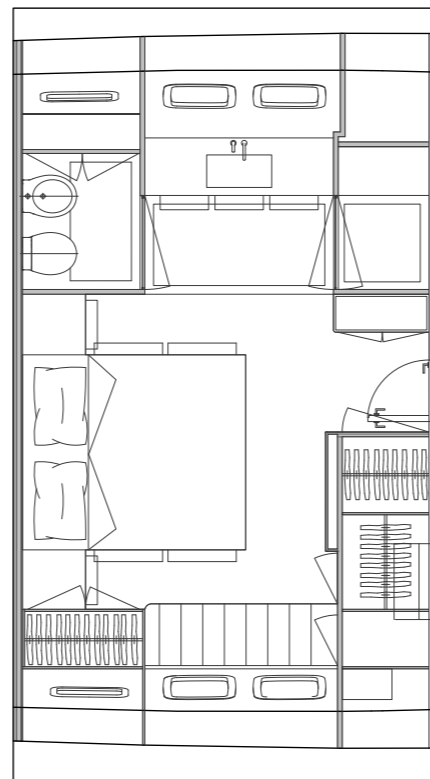

Alternative proposal
for owner cabin B

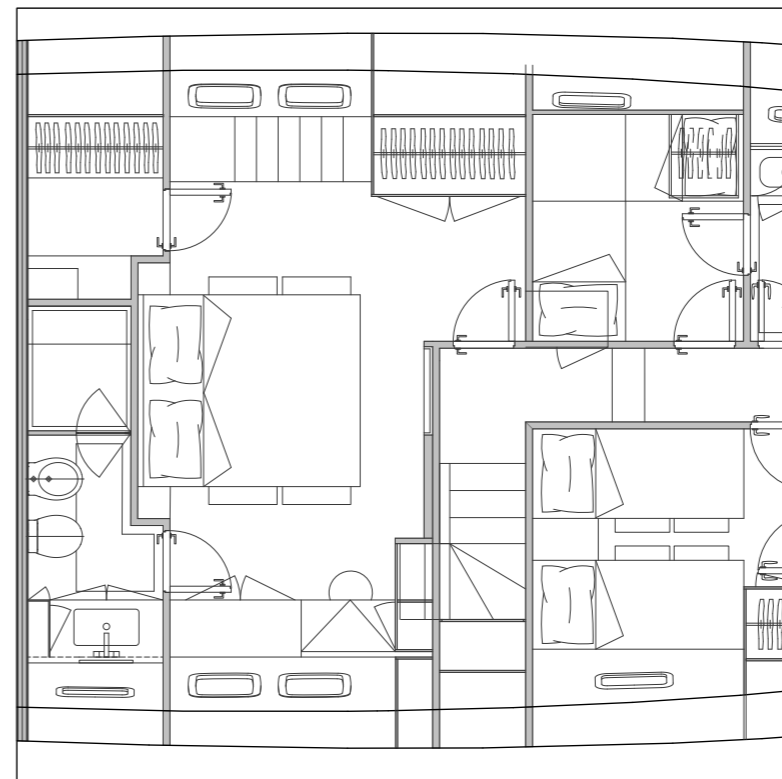

SX
76/

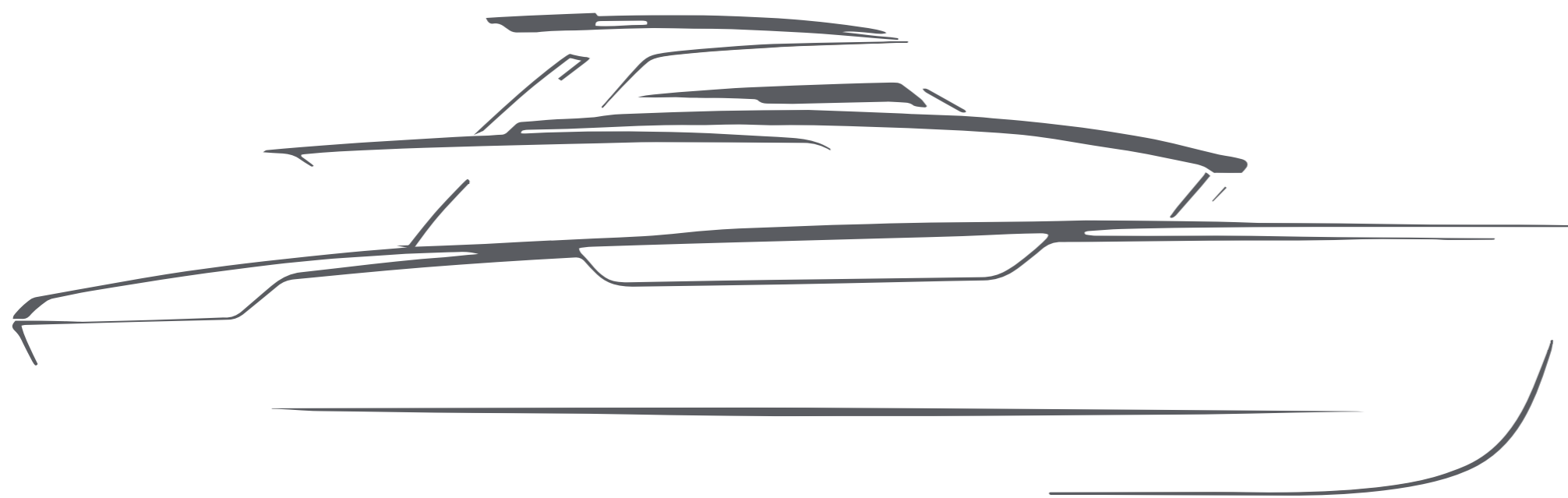

**LISSONI
ASSOCIATI**
SPECIAL
EDITION



SEE DEDICATED BROCHURE











Bathroom - Lissoni Edition

SX
76/



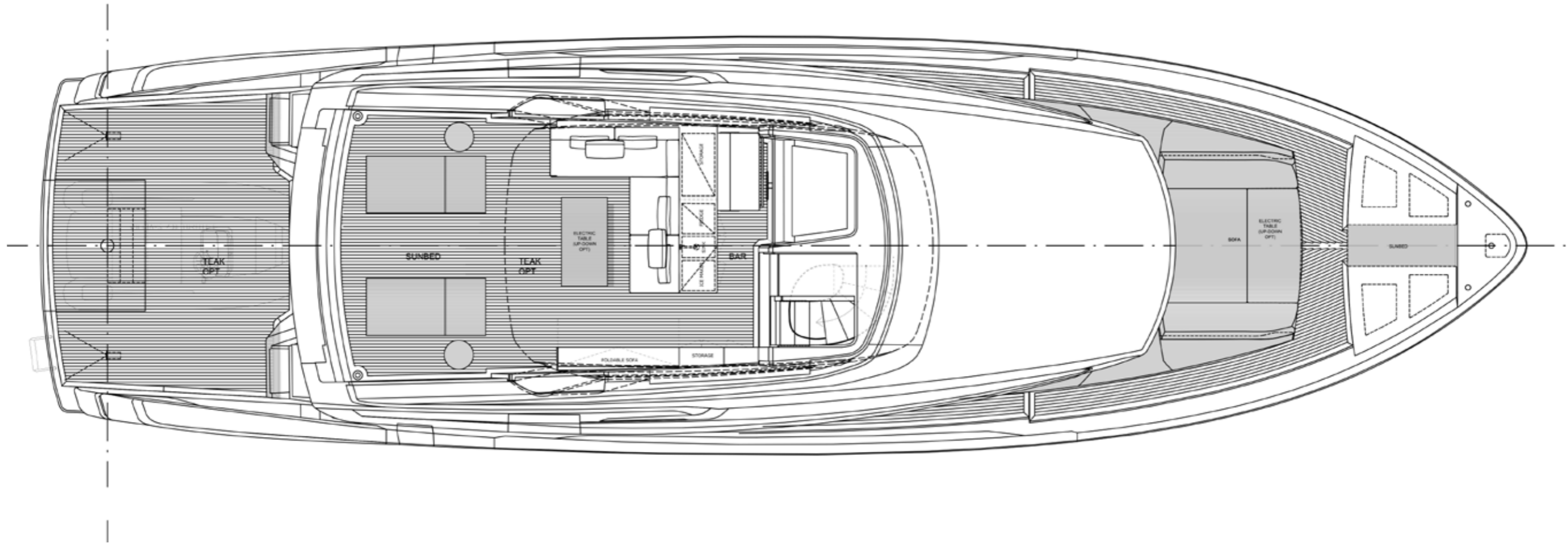

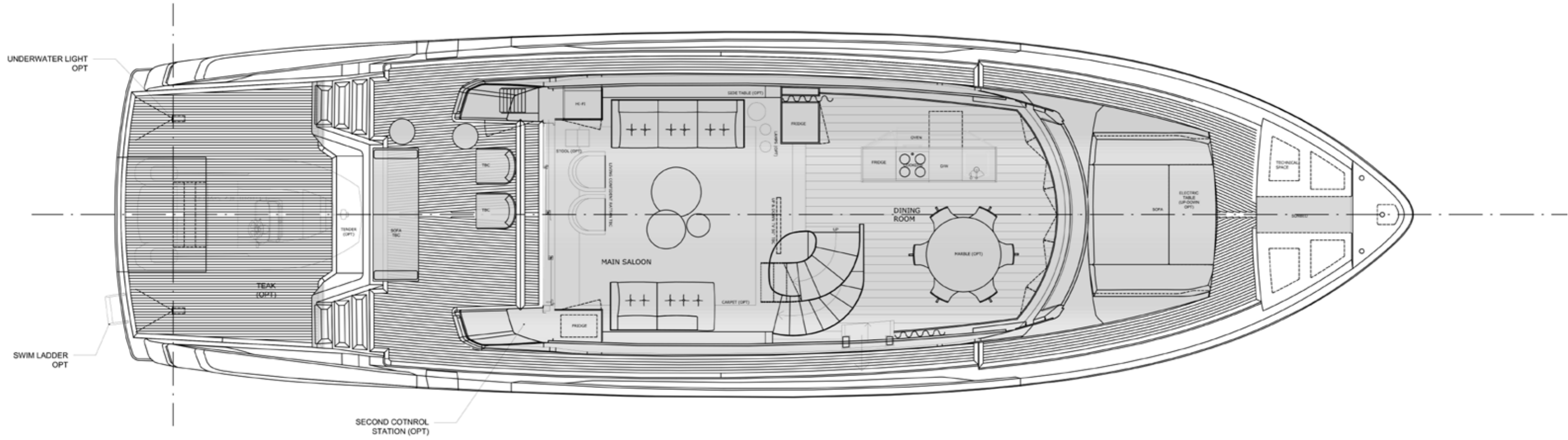

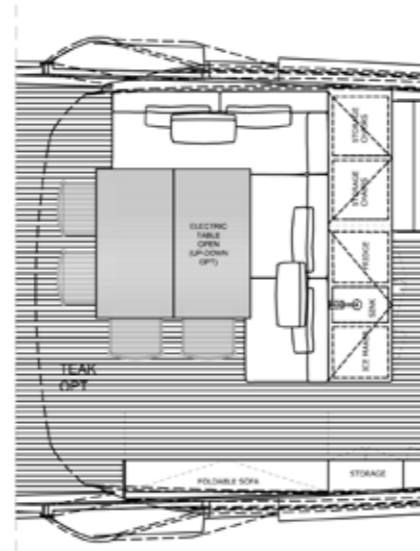
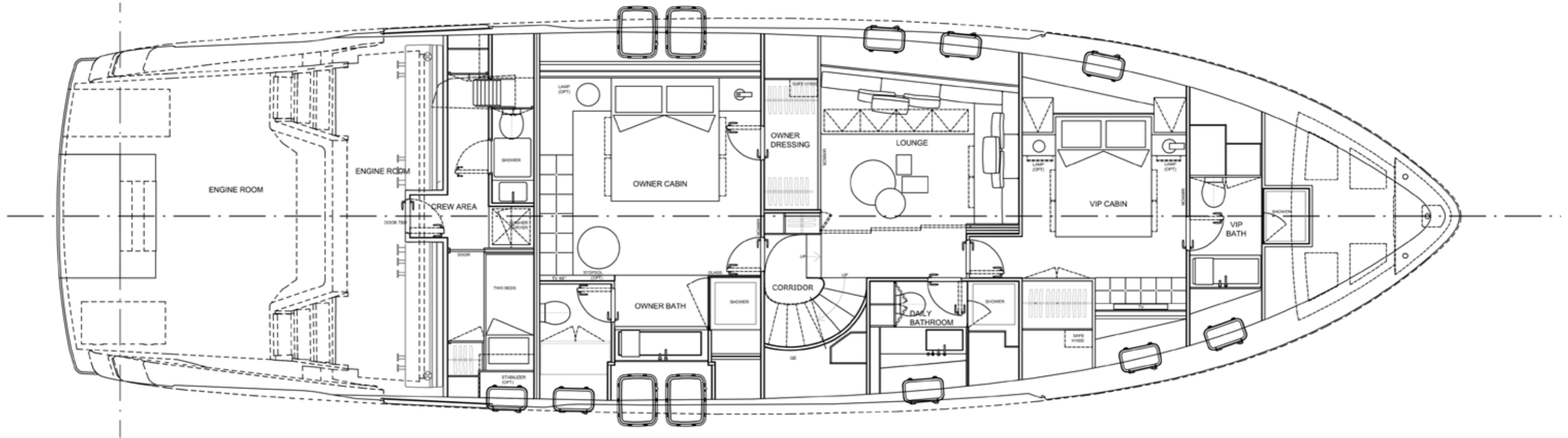

Fly bridge enclosure	Strataglass® on the sides
Low consumption lighting system	Complete Led lighting
Insulated glasses	25% Heating & UV reduction
Launching davit	Electro-Hydraulic hidden in aft gunwale
Low consumption systems	EU Class A certified systems.
Sustainable woods	FSC certified wood
Optional Extra Lithium Battery package	3 x lithium packages (up to 3 hrs hotel)
Swimming platform area	19.0 mq
Tender length	Up to 4.00 m.
Toys capacity	Laser, Jet ski, Sunfish, Jetlev Flyer

Length Overall	Lunghezza fuori tutto	23,75 m	76 ft 6 in
Length waterline	Lunghezza al galleggiamento	21,05 m	69 ft 1 in
Maximum Beam	Larghezza fuori tutto	6,60 m	21 ft 6 in
Draft @ Full Load	Immersione @ pieno carico	1,56 m	5 ft 2 in
Displacement Half Load (estimate)	Dislocamento @ mezzo carico	56 t. +/- 5%	123.700 lbs
Fuel Capacity	Capacità casse carburante	4500 l	1.189 gals.
Fresh Water Capacity	Capacità casse acqua dolce	1400 l	370 gals.
Grey Water Capacity	Capacità casse acque grigie	400 l	105 gals.
Black Water Capacity	Capacità casse acque nere	400 l	105 gals.
Engines	Motori	2 x IPS 1050 Volvo (800 HP)	2 x IPS 1050 Volvo (800 HP)
Generators	Generatori	1 x 25 Kw	1 x 25 Kw
Bow thruster	Elica di prua	Electric	Electric
Max speed	Velocità massima	22 knots +/- 5%	22 knots +/- 5%
Cruise speed	Velocità di crociera (nodi)	20 knots +/- 5%	20 knots +/- 5%
Slow cruise	Velocità economica (nodi)	12 knots	12 knots
Range @ cruising speed (nm)	Autonomia max a velocità di crociera (mn)	320 nm@ 20 knots	320 nm@ 20 knots
Range @ economic speed (nm)	Autonomia max a velocità economica (mn)	500 nm @ 12 knots	500 nm @ 12 knots

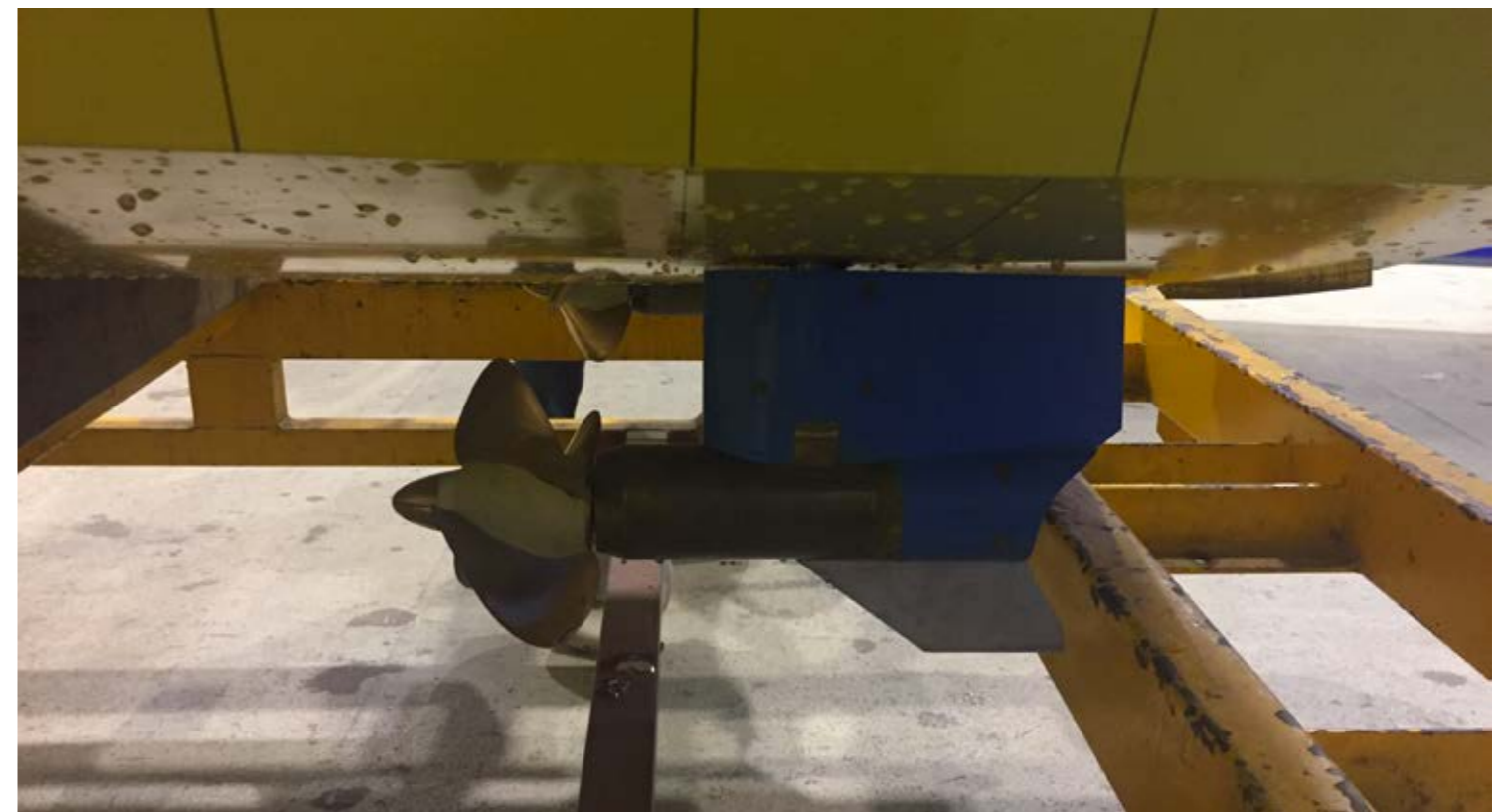

Tank testing session at Marin Institute in Wageningen, Holland

It's not an investment if it's destroying

Vandana Shiva



Infusion layup system



Bio resins & core



FSC certified woods supply



Formaldehyde free furniture

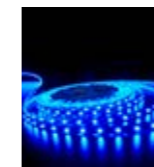

Led lighting



Bio Chrome



Sustainable leather



Class A++

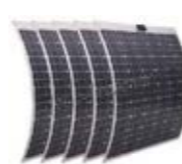

Solar panels



Hull efficiency



Thermal insulation